



PLATINUM



PLATINUM CLUB

The Platinum Club showcases contemporary Australian design with a sense of sophisticated luxury. Furnishings inspired by the land it traverses have culminated in a palette of subtle texture and materials, with crafted brass detailing to reflect the classic age of transcontinental travel.

Platinum Club is an opulent, spacious and yet intimate premium lounge and restaurant, where your clients can relax and select a cocktail from the extensive all-inclusive beverage list; enjoy an intimate dinner or a large group celebration.

Whichever your clients decide, their dedicated lounge host will be on hand to ensure all of their needs are catered for.

Luxuriously appointed, spacious cabins together with attentive but discreet, personalised service, makes Platinum Service the ultimate way to travel.

PLATINUM SERVICE INCLUDES

- All inclusive dining, beverages (alcoholic and non-alcoholic), Off Train Excursions and Off Train Experiences
- Two-course, regionally inspired lunches and five-course dinners
- Platinum Club for dining, beverages and socialising
- Transfers at the start and end of the journey complimentary within 60km radius of the rail terminal*
- Freshly prepared continental in-cabin breakfasts served upon request
- Refreshments served in-cabin
- 90kg checked luggage per guest (3 x 30kgs) plus in-cabin luggage
- En suite equipped with separate shower, vanity with cupboard space, toilet and Australian organic bathroom amenities
- In-cabin music channels and journey audio commentary available
- Picture windows offering views out both sides of the train

*Private car transfers in Sydney, Adelaide and Perth. Luxury mini coach transfer in Darwin and Alice Springs. In Brisbane, a luxury mini coach will transfer your clients to/from select city centre hotels to the central departure / check-in point. From there, Platinum Service your clients will be transferred to the terminal in a private car.

PLATINUM DOUBLE CABINS INCLUDE

- Spacious Double cabins almost twice the size of a Gold Service Twin Cabin.
- By day, the cabins are set up as a 2 seater lounge with a moveable table and two ottomans.
- By night, the lounges are converted to a double bed.

Platinum Double Cabin by day

Platinum Double Cabin by night

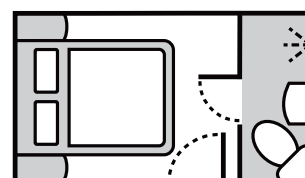
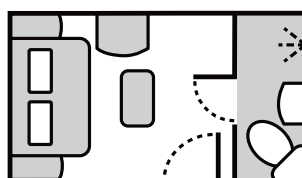

Passageway

Passageway



Platinum Twin Cabin by night

PLATINUM TWIN CABINS INCLUDE

- Spacious Double cabins almost twice the size of a Gold Service Twin Cabin
- By day, the cabins are set up as 2 lounge seats with a moveable table and two ottomans
- By night, lounges are converted to twin beds

Platinum Twin Cabin by day

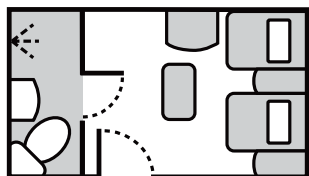

Passageway

Platinum Twin Cabin by night

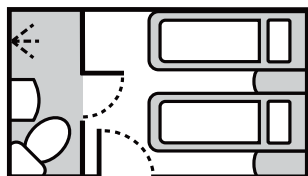

Passageway



Platinum Twin Cabin by day



Chairmans Carriage

CHAIRMANS CARRIAGE

For the ultimate group or family travel experience, your client can opt to travel in our Chairmans Carriage available on select departures of The Indian Pacific. The Chairmans carriage comprises four Platinum Service Cabins and a separate lounge area. With extremely limited availability we suggest booking well in advance.

CHAIRMANS CARRIAGE INCLUDES

- Exclusive use of this carriage and its lounge area
- 3 spacious Platinum Service Double Cabins and 1 Platinum Service Twin cabin
- By day, cabins are set up as a lounge with moveable table and 2 ottomans
- By night, in-room lounges are converted to double or twin beds
- En suite equipped with separate shower, vanity with cupboard space, toilet and Australian bathroom amenities
- Picture windows offering views from both sides of the train
- All inclusive dining, beverages (alcoholic and non-alcoholic), Off Train Excursions and Off Train Experiences
- Two-course, regionally inspired lunches and five-course dinners
- Freshly prepared continental breakfasts served upon request in cabin or in the carriage's lounge area
- Access to the Platinum Club for dining and socialising
- Transfers at the start and end of the journey available for your clients within 60kms of the rail terminal*
- 90kg luggage allowance per guest (3 x 30kg each)

*Private car transfers in Sydney, Adelaide, Alice Springs and Perth. Luxury mini coach transfer in Darwin. In Brisbane, a luxury mini coach will transfer your clients to/from select city centre hotels to the central departure / check-in point. From there, Platinum Service your clients will be transferred to the terminal in a private car.

GOLD PREMIUM

Gold Premium is more than a cabin – it's a new style of travel, with premium inclusions. It starts with the contemporary design of the cabin, where the colour palette draws inspiration from the rich colours of Arrernte painter Albert Namatjira's stunning landscapes. Think walnut timber and polished brass detailing, along with Indigenous prints on the upholstery that draw the connection to the Australian outback. Within the cabin, your clients will find high-quality luxuriously soft linen, a silk eye mask, and premium toiletries. This is their haven, a comfortable lounge by day that converts to bunk-style sleepers at night, ready to rock you to sleep with the rhythm of the train.

Gold Premium cabins have a compact ensuite with a toilet, washbasin and shower, and your clients can choose from six in-cabin music and journey commentary channels to add ambience to their travels – or enjoy the hum of the train as the soundtracks the journey.





Gold Premium Lounge, Artist Impression

GOLD PREMIUM LOUNGE

The Gold Premium Lounge is our social hub. It is the heart of the train. It's where your clients will enjoy a morning cup of coffee, a night cap in the evening. You'll meet and mingle with fellow travellers, sharing stories and reflecting on the adventures of the day. Think luxe leather banquettes and swivel chairs made for sinking into, with mood lighting creating an elegant ambiance that references the romance inherent in train travel.



Gold Premium Dining

GOLD PREMIUM DINING

Gold Premium Dining is a feast in multiple ways, with a contemporary design that respects Art Deco as the setting for carefully curated meals, from hearty breakfasts to two-course regionally inspired lunches and delectable four-course dinners, featuring the finest ingredients from local suppliers, farmers and providores. Naturally, this is accompanied by a selection of premium Australian wines.



Gold Premium Cabin by night

GOLD PREMIUM INCLUDES

- A newly designed, contemporary cabin that converts from a lounge by day into sleeping berths at night
- A private compact en suite with a shower and toilet
- Premium amenities, luxuriously soft linen and silk eye masks
- Exclusive access to the Gold Premium Lounge for premium beverages and socialising
- All-inclusive dining in the Gold Premium Dining carriage
- Two-course, regionally inspired lunches and four-course dinners
- Premium Australian wines, beers, spirits and non-alcoholic beverages throughout their journey
- Immersive Off Train Experiences and preferences on tour selections
- In-cabin music channels and journey audio commentary
- 75kg checked luggage allowance per guest (3 x 25kg each to be checked in to the luggage car, plus one small carry-on bag / piece of hand luggage, stored in your cabin)
- Priority luggage check-in on departure

Gold Premium Cabin by day

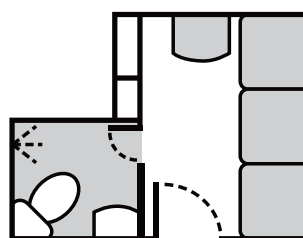

Passageway

Gold Premium Cabin by night

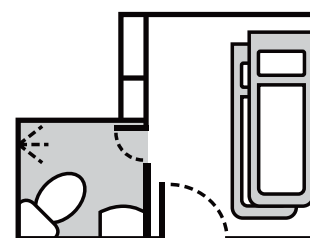

Passageway



GOLD



Outback Explorer Lounge

Tastefully appointed private accommodation, Gold Service is the most popular level of service sought by our travellers.

GOLD SERVICE INCLUDES

- All-inclusive dining in the Queen Adelaide Restaurant, Off Train Excursions and Off Train Experiences
- Access to the Outback Explorer Lounge for beverages and socialising with all-inclusive Australian wines, beers, spirits, and non-alcoholic beverages
- In-cabin safe
- In-cabin music channels and journey audio commentary
- Complimentary Australian bathroom amenities
- Complimentary shuttle bus transfers available between Darwin and Brisbane terminals and the city centres (selected hotels only)
- 60kg checked luggage allowance per guest (2 x 30kgs)

OUTBACK EXPLORER LOUNGE

Pre-dinner, after a meal, during the day or night and often late into the evening, the Outback Explorer Lounge is the social hub of the train. Exclusive to Gold Service travellers, it's where old friends and new acquaintances can gather for a coffee or a glass of wine and conversation.

- Wide range of all-inclusive beers, wines, spirits, cocktails and non-alcoholic beverages (barrista style coffee, variety of teas, juice, soft drinks and water).
- Engaging social atmosphere.
- Windows on both sides ideal for viewing the passing landscape and wildlife.



Queen Adelaide Restaurant

QUEEN ADELAIDE RESTAURANT

The Queen Adelaide Restaurant is a delightful and charming dining carriage, where your clients will enjoy sumptuous meals while spectacular scenery sweeps past the window.

- Fully cooked breakfasts, two-course lunches, three-course dinners.
- Flexible reservation options with pre-booking available on train.
- Regionalised restaurant-quality menus freshly prepared by on board chefs.
- Vegetarian, gluten-free options available with other dietary requirements catered for (must be advised at time of booking).



Queen Adelaide Restaurant



Gold Single Cabin by night



Gold Twin Cabin by night

GOLD SINGLE CABINS INCLUDE

- A compact sleeper cabin featuring a bed that converts to a seat by day, private vanity, with shared shower/toilet facilities located at the end of the carriage.

Gold Single Cabin by day

Gold Single Cabin by night

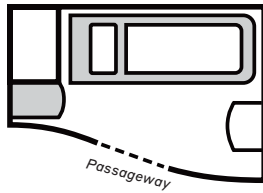
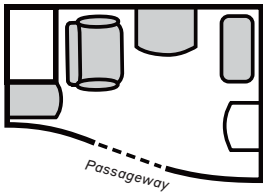

GOLD TWIN CABINS INCLUDE

- A comfortable sleeper cabin featuring upper and lower sleeping berths that convert to a three-seater lounge by day
- Private en suite featuring a compact shower and toilet.

Gold Twin Cabin by day

Gold Twin Cabin by night

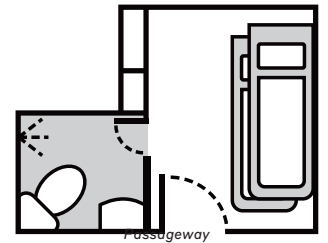
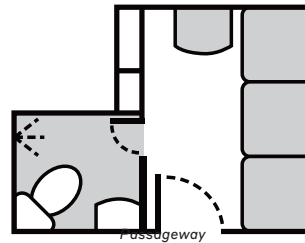

Gold Suite Cabin by day

GOLD SUITE* CABINS INCLUDE

- A ¾ size double bed and additional fold down upper berth.
- Private en suite featuring a compact shower and toilet.
- Mini bar fridge with included beverages.

*Limited availability.

Gold Suite Cabin by day

Gold Suite Cabin by night

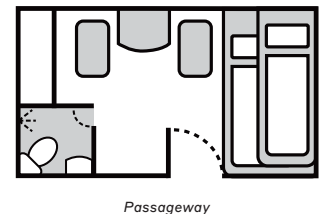
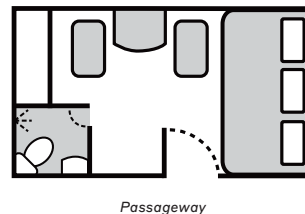



THE GHAN



Departing Adelaide, travel through the Red Centre, experiencing Australia at its dramatic best on The Ghan. Watch the landscape change from verdent greens to arid plains, where the colours of the outback saturate the landscape. Stop in Marla, Alice Springs and Katherine to learn about the history, culture and significance of each remote outpost as you travel on this legendary train. Or, experience the return journey in March and November and stop in Manguri for an evening experience.



Departures

Northbound

Adelaide – Alice Springs – Darwin

Departs Sunday (Mar-Nov) & Wednesday (Apr-Oct)

Southbound

Darwin – Alice Springs – Adelaide

Departs Wednesday (Mar & Nov)



Off Train Experiences^

Alice Springs: With a morning or afternoon in 'The Alice', it's yesteryear once more. Visit the local landmarks. Take a front row seat to a spectacular bird show at the Desert Park. Or view the permanent waterhole at Simpsons Gap. Clients can also choose to upgrade to the Spirit of Mount Gillen Helicopter Flight.

Katherine: Experience one of the Top End's most impressive natural wonders on a cruise along Nitmiluk Gorge. Making this experience even more memorable is the commentary that explains the significance of Nitmiluk to the Indigenous Jawoyn people and the many stories that celebrate their spiritual connection to the gorge. There is also a helicopter flight upgrade available, for those wishing to see Nitmiluk from an aerial perspective. Alternatively, the Katherine Outback Experience lets your clients into the lives of those who call the outback home.

Marla (northbound): Set foot in the remote reaches of South Australia to witness an unforgettable outback sunrise on this early morning stop.

Manguri (southbound): Your clients can experience a glittering showcase of outback stars when disembarking for this spectacle after dinner.





Telegraph Station Dinner, Alice Springs, NT

THE GHAN EXPEDITION

 4 DAYS

A unique and epic experience, explore the wonders of Australia's vast interior on one of the world's most renowned rail journeys. Beginning in Darwin, this 4-day, all-inclusive journey takes your clients to some of the most remote and captivating parts of Australia in style and comfort. Their adventure through the country's vast, varied, and captivating interior will show them the true meaning of the Australian outback. In the Northern Territory, explore Katherine and Alice Springs, where they'll enjoy a signature dining experience at the Telegraph Station, and in South Australia, visit Manguri and Coober Pedy before reaching their final destination of Adelaide.



Departures

Darwin – Alice Springs – Adelaide

Departs Wednesday & Saturday (Apr-Oct)

Off Train Experiences[^]

Katherine: In a region renowned for jaw-dropping natural assets, Katherine boasts one of the Top End's best – the incredible Nitmiluk Gorge – and a cruise is on offer to showcase the beauty of this spot. Alternatively, the Katherine Outback Experience brings your clients closer to those who call the outback home, while the Cutta Cutta Cave system is home to a variety of native wildlife and is rich in Indigenous culture and modern European history. Or, take it all in from the air, with an optional upgrade helicopter flight over Nitmiluk.

Alice Springs: There's an experience to suit everyone, including an off-road e-bike adventure, the Alice Explorer tour that takes in the Royal Flying Doctor Service and the stunning views at ANZAC Hill, a cultural experience at Standley Chasm, meeting the wildlife at the Desert Park, or taking in the astounding beauty of Simpson's Gap. Alternatively, spot Uluru and Kata Tjuta from the air, with an optional upgrade scenic flight.

In the evening, the hallmark experience of The Ghan Expedition begins. Your clients will under a blanket of stars at the Alice Springs Telegraph Station, with red earth at their feet and white tablecloths under their fingertips. This will be a night to remember.

Coober Pedy: Venture into the weird and wonderful opal mining township of Coober Pedy, where more than half of the residents live underground. Enjoy a day of discovery and a gourmet lunch in the most unique of locations: underground. Off Train Experiences on offer include exploring the majestic Breakaways, touring the town, learning more about mining history on the Opal Experience, or an optional upgrade with the Painted Hills and Lake Eyre scenic flight.

[^]Off Train Experiences are subject to availability and are subject to change.