



EXPERIENCE GUIDE

2022





INTRODUCING MELBOURNE SKYDECK

Located in the heart of the city, Melbourne Skydeck captures everything that is special about Melbourne and beyond. Featuring the Southern Hemisphere's highest observation deck, the Melbourne Skydeck experience dazzles, entertains and informs through its spectacular and ever-changing views, state-of-the-art virtual and augmented reality technology (VR/AR), Melbourne Skydeck App and Bar 88 Champagne bar.

Be prepared to have your perceptions of reality challenged.

Be prepared to be wowed.

This is Melbourne, on another level!



DID YOU KNOW?

- Melbourne Skydeck is found within Eureka Tower on Melbourne's Southbank, with its top ten floors plated in 24-carat gold
- Voyager Theatre is the first—and largest—virtual reality theatre of its kind in the Southern Hemisphere
- Melbourne Skydeck is the tallest public observation deck in the Southern Hemisphere
- At 295 metres above ground level, visitors can see up to 75 kilometres in every direction on a clear day
- Melbourne Skydeck is home to the fastest elevator in the Southern Hemisphere, travelling at the speed of nine metres per second, reaching the top in a little under 40 seconds
- Send a postcard from the 88th floor—Australia's highest letterbox
- The top of Eureka Tower can flex up to 600mm in high winds
- There is enough glass to cover the MCG twice and enough concrete to fill 44 Olympic size swimming pools (110,000 tonnes)
- There are 3,680 steps from bottom to top





TO PUT THINGS IN PERSPECTIVE

At 297 metres tall, Eureka Tower is taller than:

- World Trade Centre Doha (241m)
- Big Ben, UK (96m)
- The Statue of Liberty, US (93m)
- Christ the Redeemer, Brazil (38m)
- Rialto Towers, Melbourne (270m)
- Sydney Harbour Bridge (49m)

Its taller siblings include:

- The Eiffel Tower, Paris (324m)
- The UK's Shard (310m)
- The Empire State Building, US (443m)

LOOKING BACK

The 2021 launch of Melbourne Skydeck is the latest chapter in the robust history of Eureka Tower, which was built over four years and completed in 2006. For three years, it was the world's tallest residential tower until the Ocean Heights building in Dubai was completed in 2009. Currently, it's Australia's third tallest building after Queensland's Q1 and Melbourne's Australia 108.

Eureka Tower's unique design pays homage to the Eureka Stockade, a notable rebellion in Australia's history when gold prospectors clashed with the government during the Victorian gold rush. The top ten floors of Eureka Tower are plated in 24-carat gold, a tribute to the gold rush era, while its red stripe symbolises the blood shed during the stoush.

One level up from Melbourne Skydeck is Eureka 89 – the Southern Hemisphere's highest restaurant and bar at an astounding 292 metres high. Enjoy a chef's tasting menu and fine wine with a generous side of panoramic views.



ACKNOWLEDGEMENT OF TRADITIONAL LAND OWNERS

"We acknowledge the Wurundjeri people as the Traditional Custodians of the land we are on. We recognise their continuing connection to the land and waters and thank them for protecting this coastline and its ecosystems since time immemorial. We pay our respects to Elders past and present and extend that respect to all First Nations people present today."

ATTRACTIONS

SKYDECK EXPERIENCE

At Skydeck, the Southern Hemisphere's highest viewing attraction, the City of Melbourne comes alive before your eyes when you take it all in from nearly 300 metres high. It's Melbourne on another level.

The Skydeck experience features Bar 88, in association with Bollinger Champagne, operated by the Eureka 89 team. With 360° panoramic views all day, at sunset you can relax and enjoy Melbourne's legendary views with delicious food and cool drinks.



VOYAGER
THEATRE

THE ALL-NEW VIRTUAL REALITY VOYAGER® THEATRE

Become part of the stories of Melbourne with an exceptional VR experience that's the largest of its kind in the Southern Hemisphere. The immersive sensory experience will have you seeing, feeling, hearing and smelling your way through Melbourne via 24 award-winning Positron Voyager virtual reality 'pod' chairs.

Brace yourself for this 360-degree cinematic journey, travelling through 16 iconic Melbourne experiences including festivals, laneways, Yarra River, sporting events and Victoria's stunning scenery, experiencing Super 8K high-definition and 6-D sensations.

The chairs feature movement, vibrations, and scents, from aromas of freshly roasted coffee and roses in the Melbourne Cup winners' circle to the smell of crisp ocean air above the Great Ocean Road.

Complete with a stunning score created by Melbourne music legends Felix Riebl and Ollie McGill of The Cat Empire, this 11-minute journey is sure to awaken the senses and deliver you right into the heart of Victoria.

Voyager®, made by Positron, is the first chair designed specifically for fully immersive cinematic VR. From its gleaming, futuristic shell to its plush, lounge-style seat, Voyager® is precision engineered to take your VR viewing experience to the next level, with a range of premium features.



EDGE EXPERIENCE

There's the view. Then there's standing suspended 88 floors above the city with nothing but a transparent glass floor beneath you. Thrill-seekers keen to push the boundaries, step into the Edge.

A world-first, the Edge suspends daring guests in a transparent glass cube projecting out from Melbourne Skydeck, leaving them suspended nearly 300 metres above the streets of Melbourne.

Challenge your friends, face your fears, and capture this moment with a photo package for just \$18.

EDGE



PLANK – VIRTUAL REALITY

Melbourne Skydeck's VR Plank Experience is so compelling it convinces even the bravest contenders they're balancing on a narrow plank at dizzying heights above Melbourne.

With two feet firmly planted on the ground and a VR headset on, feel the wobble of the thin Plank. A bird's eye view of Melbourne surrounds you before ziplining into the heart of the city.

A bewildering challenge for children and adults alike, this VR experience demands those who dare to put mind over matter to conquer the Plank!

PLANK



AUGMENTED REALITY 3-D MODEL OF MELBOURNE

The new AR model of Melbourne is an impressive 3-D model of the city built to an accurate scale of 1:1000.

Six digital tablets surround the table providing interactive AR windows into Melbourne's diverse past, showcasing the development and stories of Melbourne through the various epochs of time. Visitors scroll between eight periods of the city's history, seeing actual 3-D projections of the historical footprint starting from pre-settlement all the way through to the future of Melbourne. The backdrop to the model is a gigantic digital wall featuring more stories of Melbourne, bringing the magic of Melbourne to life in an informative and entertaining way.

Fun facts:

- There are over 184 pieces in the model, taking almost 2240 hours (or 93 days) to print using four printers
- The central file includes volumes of data and details not existing anywhere in other 3-D cadastral (showing boundaries of land and ownership) models to date
- There were 40 3-D AR models collected to create the activation
- Data was interpreted and projected by Monash architecture professor, Dr. Tom Morgan, whose research has helped create ideas of the future image of Melbourne – the city beyond.



MELBOURNE SKYDECK APP

An interactive Melbourne Skydeck App that educates, surprises and delights. Guests are invited to download the App upon arrival to unlock a world of discovery. Strategically positioned throughout Melbourne Skydeck are 31 markers. Search and scan to discover Melbourne landmarks and iconic international towers – all in 3-D. Uncover all 31 markers and show your collection to a team member in the retail store to claim your free Melbourne Skydeck branded gift.

BAR 88

Complete your experience with a visit to Bar 88, an exciting collaboration between Melbourne Skydeck, Eureka 89 fine dining and Bollinger Champagne. For an elevated experience, choose from a range of sophisticated delights including Pacific oysters, a seasonal cheese plate, or chicken liver pate carefully crafted by our award-winning executive chef.

Complement this with our range of cocktails, fine wines, or a glass of Bollinger Champagne, all while drinking in the panoramic views. If you're looking for a coffee, soft drink and a heartier snack, a range of gourmet pastries including pies, pasties and sausage rolls are also available.

BAR 88





One level up from Melbourne Skydeck is Eureka 89, a unique space for spectacular events and regularly scheduled degustation dinners. Eureka 89 combines a sophisticated dining experience with incredible views of Melbourne and beyond.

Award-winning chef Renee Martillano creates seasonal menus showcasing the best Victorian produce which are then carefully paired with Australian fine wines.

Eureka 89 is a great choice for celebrating a special occasion, hosting gatherings and events or for visitors wanting to experience Melbourne on another level.

EUREKA 89

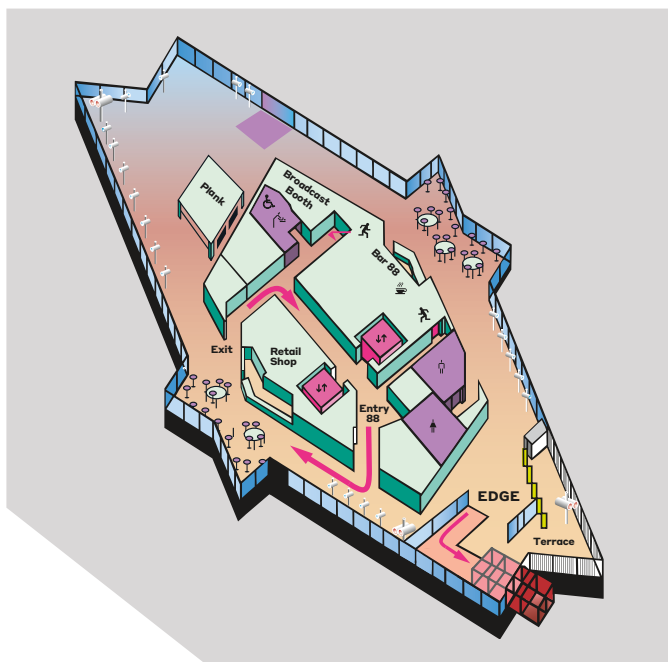

WHERE & WHEN

HOURS OF OPERATION:

Open 7 days

12:00pm to 10:00pm

Please note: Melbourne Skydeck will be CLOSED Christmas Day and closed from 5pm on New Year's Eve for our NYE event.

Opening hours may differ throughout the year, please check our website for details.

LOCATION

Riverside Quay, Southbank
Melbourne, 3006

(03) 9693 8888

PARKING

Parking is available directly beneath Melbourne Skydeck in the Wilson Eureka Carpark* on the corner of City Road and Southgate Avenue (enter from Southgate Avenue). Discounted flat rate parking is available for all guests of Melbourne Skydeck and Eureka 89.

Monday – Friday (entry prior to 4:00pm) \$13.00*

Monday – Friday (entry after 4:00pm) \$6.00*

Weekends \$11.00*

*This carpark is owned and operated by Wilson Parking and prices are subject to change without notice.

GROUPS & EVENTS

EDUCATION GROUP BOOKINGS & EDUCATIONAL EXPERIENCES

A visit to Melbourne Skydeck makes for an informing, engaging and inspiring learning experience for all ages. With experiences structured around the Victorian curriculum, our dedicated Education Coordinator will help school groups get the most out of their excursion.

We have a range of educational resources and suggestions to help schools tailor a program that maximises learning for their students. For school and educational institute groups, please book through Melbourne Skydeck's Education Department at schools@melbourneskydeck.com.au





GROUP BOOKINGS

Looking for a unique activity for your sporting club, youth group or seniors club? Get the group together and visit Melbourne Skydeck for an activity with a difference. We can tailor your experience to focus on team building or organise a competition for those with a competitive streak. There's something for everyone.

Melbourne Skydeck welcomes group bookings and is pleased to offer discounted admission tickets to groups of 20 guests or more*. If you have a valid Australian Seniors Card, you will receive a special senior discount.

To make a group booking, please e-mail groups@melbourneskydeck.com.au or phone (03) 9693 8888 so we can help organise your visit.

*Group ticket prices for groups of 20 or more are \$17.50 per person. Tickets include entry to Skydeck, and group leaders go free of charge.

Terms & Conditions: Pre-booking is required. Group bookings of 20 or more guests may request exclusive access from 10:00am to 12:00pm. Payment must be made on the day of visit prior to entry in one single transaction. Additional experiences can be purchased on the day of your visit.

SKY HIGH ROMANCE

Create a moment that you and your loved one will treasure forever. A proposal at Melbourne Skydeck takes romance to another level. Sweep your partner off their feet when you pop the question 295 metres above Melbourne, surrounded by 360° sweeping sunset views.

The team at Melbourne Skydeck are specially trained to deliver magical proposals and can work with you to ensure the moment goes off without a hitch.

The Sky-High Gold Package is designed to help you create the perfect moment and includes:

- Skydeck entry and Edge experience for two people (Voyager Theatre not included).
- Exclusive Edge experience where you can propose privately (no other guests in the Edge).
- Two complimentary photos to have a long-lasting memory of your special moment.
- The package is \$179.

To arrange your special moment, contact our team via admin@melbourneskydeck.com or phone (03) 9693 8888.

IMAGES & FILMING AT MELBOURNE SKYDECK

Melbourne Skydeck is no stranger to film crews and our team is happy to assist you with quotes, access, and recommendations for getting the best vision. Please contact public.relations@journeybeyond.com if you are interested in filming at Melbourne Skydeck or would like to request access to high-resolution images for publication.



RETAIL STORE

Choose a unique memento to celebrate and remember your visit to Melbourne Skydeck. Alternatively, if you're unable to visit or know someone who would like to share in its magic, visit our online store to send a gift or purchase a voucher at [journeybeyond.com](https://www.journeybeyond.com).



JOURNEY BEYOND

Australia's leading experiential tourism group, Journey Beyond, is privileged to own and operate 13 brands spanning the country, connecting guests to the land, and to each other.

Headquartered in Adelaide, Journey Beyond formed in 2016 and now comprises of tourism brands including: iconic trains The Ghan, Indian Pacific, Great Southern and The Overland; small-group outback operator Outback Spirit; eco-luxe lodge Sal Salis Ningaloo Reef; aquatic adventures Cruise Whitsundays, Rottnest Express, Horizontal Falls Seaplane Adventures, Darwin Harbour Cruises and Journey Beyond Cruise Sydney; and our tallest members, Melbourne Skydeck and Eureka 89.

Visit [journeybeyond.com](https://www.journeybeyond.com) and join us as we take the amazing and turn it into breathtaking.

TICKETING PRICING & PACKAGES

	Adult (17 years +)	Child (4 to 16 years)	Family (2 Adults, 2 Children)
INDIVIDUAL TICKETS	Gross (AUD)	Gross (AUD)	Gross (AUD)
Melbourne Skydeck Entry	\$28.00	\$18.00	\$78.00
Edge	\$14.00	\$9.50	\$40.00
Plank	\$8.00	\$6.50	\$25.00
Voyager Theatre	\$14.00	\$11.50	\$44.00
PACKAGES			
Voyager Experience ► Skydeck Entry + Voyager Theatre	\$41.00	\$29.00	\$119.00
Skydeck Adventurer ► Skydeck Entry + Edge + Plank	\$47.00	\$32.00	\$140.00
Thrill Seeker ► Skydeck Entry + Voyager Theatre + Edge	\$52.00	\$37.00	\$157.00
MAX VR Experience ► Skydeck Entry + Voyager Theatre + Plank	\$46.00	\$33.00	\$142.00
Ultimate Skydeck ► Skydeck Entry + Voyager Theatre + Edge + Plank	\$58.00	\$42.00	\$179.00

*Prices based on online bookings and are subject to change

SKYDECK ANNUAL PASS

Melbourne Skydeck's Annual Pass provides members with unlimited entry to Melbourne Skydeck, along with exclusive discounts on experiences, food and beverage, merchandise and more.

Annual Skydeck Membership Benefits Include:

- 12-month unlimited express entry to Melbourne Skydeck, including Bar 88
- 20% off Bar 88 and Melbourne Skydeck retail shop purchases
- 20% off Melbourne Skydeck online retail store
- 25% off Edge experience for you and your guests (up to 4 guests per visit)
- 1 complimentary Edge photo package
- 20% off Voyager Theatre for you and your guests (up to 4 guests per visit)
- 50% off general admission tickets for family and friends (8 per membership, per year)
- Discounted parking at Wilson Eureka carpark

Annual Membership Prices:

- Child (4 to 16 years) \$55.00
- Concession \$75.00
- Adult \$80.00
- Family (2 Adults & 2 Children 4-16 years) \$200.00
- Additional Child (4-16 years only with Family Membership) \$40.00

Melbourne Skydeck annual membership are available for purchase at the admissions counter.



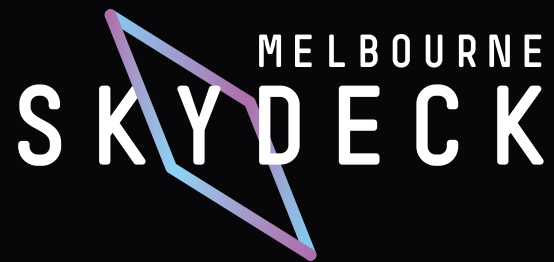

@melbourneskydeck



@melbourneskydeck

MELBOURNESKYDECK.COM.AU